

CERTIFICATION
 THE UNDERSIGNED HAS OBTAINED "PREPARE A WORK ZONE TRAFFIC MANAGEMENT PLAN" CERTIFICATION.
 CERTIFICATE NO: TCT1036878
 JAMES GOODMAN

TRAFFIC CONTROLLER NOTES:

- 5 X TRAFFIC CONTROLLERS REQUIRED FOR FULL DURATION OF WORKS TO CONTROL PEDESTRIAN MOVEMENTS AT HUNTER STREET/PITT STREET/O'CONNELL STREET INTERSECTION
- 2 X TRAFFIC CONTROLLERS REQUIRED TO GUIDE VEHICLES WHILST VEHICLES ARE ENTERING AND EXITING THE SITE AT HUNTER STREET/PITT STREET/O'CONNELL STREET INTERSECTION
- 3 X SITE PERSONNEL REQUIRED FOR FULL DURATION OF WORKS AT HAMILTON PLACE/HUNTER STREET INTERSECTION
- PEDESTRIAN FOOTPATHS ON HUNTER STREET
- POLICE TRAFFIC CONTROL REQUIRED FOR FULL DURATION OF WORKS AT HUNTER STREET/BLIGHT STREET/CASTLEREAGH STREET INTERSECTION, GEORGE STREET/HUNTER STREET/INTERSECTION, AND HUNTER STREET/PITT STREET/O'CONNELL STREET INTERSECTION

ALL PARKING RESTRICTIONS ON BLIGHT STREET WILL BE CONVERTED TO BUS OVERLAY ZONES DURING THE CLOSURE

TRAFFIC CONTROLLERS TO CONTROL PEDESTRIAN MOVEMENTS ON EACH LEG WHILST POLICE CONTROL THE INTERSECTION

TRAFFIC CONTROLLERS WILL ASSIST HEAVY VEHICLES WHILE ENTERING AND EXITING THE SITES FROM PITT STREET

LEGEND

- SUBJECT SITE
- CRANE WORK ZONE
- TEMPORARY CRANE WORK ZONE
- B-CLASS HOARDING
- PEDESTRIAN ROUTE
- TRAFFIC CONES
- TRAFFIC FLOW
- SIGN POST
- TRAFFIC CONTROLLER
- POLICE TRAFFIC CONTROLLER
- SITE PERSONNEL

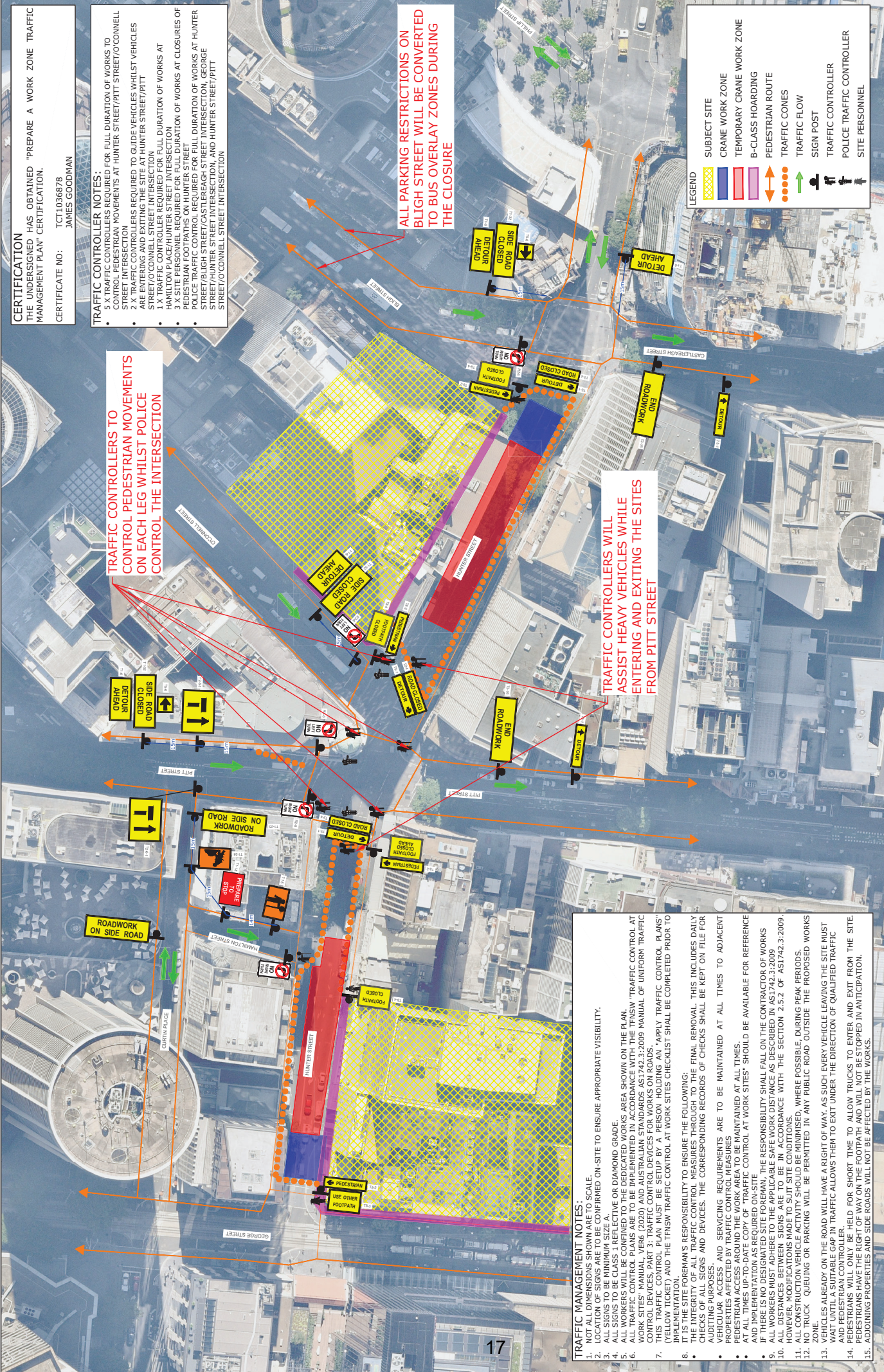

TRAFFIC MANAGEMENT NOTES:

- SCALE
- LOCATION OF SIGNS ARE TO BE CONFIRMED ON-SITE TO ENSURE APPROPRIATE VISIBILITY.
- ALL SIGNS TO BE MINIMUM SIZE A.
- ALL WORKERS WILL BE CLASS 1 REFLECTIVE OR DIAMOND GRADE.
- ALL TRAFFIC CONTROL PLANS ARE TO BE IMPLEMENTED IN ACCORDANCE WITH THE TNSW "TRAFFIC CONTROL AT WORK SITES" MANUAL, VER6 (2020) AND AUSTRALIAN STANDARDS AS1742.3:2009 MANUAL OF UNIFORM TRAFFIC CONTROL DEVICES (MUTCD) AND THE TNSW "TRAFFIC CONTROL PLANS" CHECKLIST.
- THIS TRAFFIC CONTROL PLAN MUST BE SETUP BY PERSON HOLDING AN "APPLY TRAFFIC CONTROL PLANS" (YELLOW TICKET) AND THE TNSW TRAFFIC CONTROL AT WORK SITES CHECKLIST SHALL BE COMPLETED PRIOR TO IMPLEMENTATION.
- IT IS THE SITE FOREMAN'S RESPONSIBILITY TO ENSURE THE FOLLOWING:
 - THE INTEGRITY OF ALL TRAFFIC CONTROL MEASURES THROUGHOUT TO THE FINAL REMOVAL. THIS INCLUDES DAILY CHECKS OF ALL SIGNS AND DEVICES. THE CORRESPONDING RECORDS OF CHECKS SHALL BE KEPT ON FILE FOR VERIFICATION.
 - VEHICULAR ACCESS AND SERVICING REQUIREMENTS ARE TO BE MAINTAINED AT ALL TIMES TO ADJACENT PROPERTIES AFFECTED BY TRAFFIC CONTROL MEASURES
 - PEDESTRIAN ACCESS AROUND THE WORK AREA TO BE MAINTAINED AT ALL TIMES.
 - AT ALL TIMES UP-TO-DATE COPY OF "TRAFFIC CONTROL AT WORK SITES" SHOULD BE AVAILABLE FOR REFERENCE AND IMPLEMENTATION AS REQUIRED ON-SITE
 - IF THERE IS NO DESIGNATED SITE FOREMAN, THE RESPONSIBILITY SHALL FALL ON THE CONTRACTOR OF WORKS
 - ALL DISTANCES BETWEEN SIGNS ARE TO BE IN ACCORDANCE WITH THE SECTION 2.5.2 OF AS1742.3:2009. HOWEVER, MODIFICATIONS MADE TO SUIT SITE CONDITIONS.
 - ALL CONSTRUCTION VEHICLE ACTIVITY SHOULD BE MINIMISED, WHERE POSSIBLE, DURING PEAK PERIODS.
 - NO TRUCK QUEUING OR PARKING WILL BE PERMITTED IN ANY PUBLIC ROAD OUTSIDE THE PROPOSED WORKS ZONE.
 - VEHICLES ALREADY ON THE ROAD WILL HAVE A RIGHT OF WAY AS SUCH EVERY VEHICLE LEAVING THE SITE MUST BE HELD IN A SUITABLE STOP. TRAFFIC ALLOWS THEM TO EXIT UNDER THE DIRECTION OF QUALIFIED TRAFFIC AND PEDESTRIAN CONTROLLER.
 - PEDESTRIANS WILL ONLY BE HELD FOR SHORT TIME TO ALLOW TRUCKS TO ENTER AND EXIT FROM THE SITE. PEDESTRIANS HAVE THE RIGHT OF WAY ON THE FOOTPATH AND WILL NOT BE STOPPED IN ANTICIPATION.
 - ADJOINING PROPERTIES AND SIDE ROADS WILL NOT BE AFFECTED BY THE WORKS.

REV.	DESCRIPTION	DRAWN	CHECK	APP'D	DATE
A		JG	DL	WJ	11/07/24

PROJECT: SYDNEY METRO WEST
 HUNTER STREET - HEAVY LIFT CRANAGE
 TITLE: TRAFFIC GUIDANCE SCHEME

DWG No. 21480CAD013
 DATE STAMP 11 JULY 2024
 PROJECT No. 21480
 SCALE NTS
 REV. A

CERTIFICATION
 THE UNDERSIGNED HAS OBTAINED "PREPARE A WORK ZONE TRAFFIC MANAGEMENT PLAN" CERTIFICATION.
 CERTIFICATE NO: TCT1036878
 JAMES GOODMAN

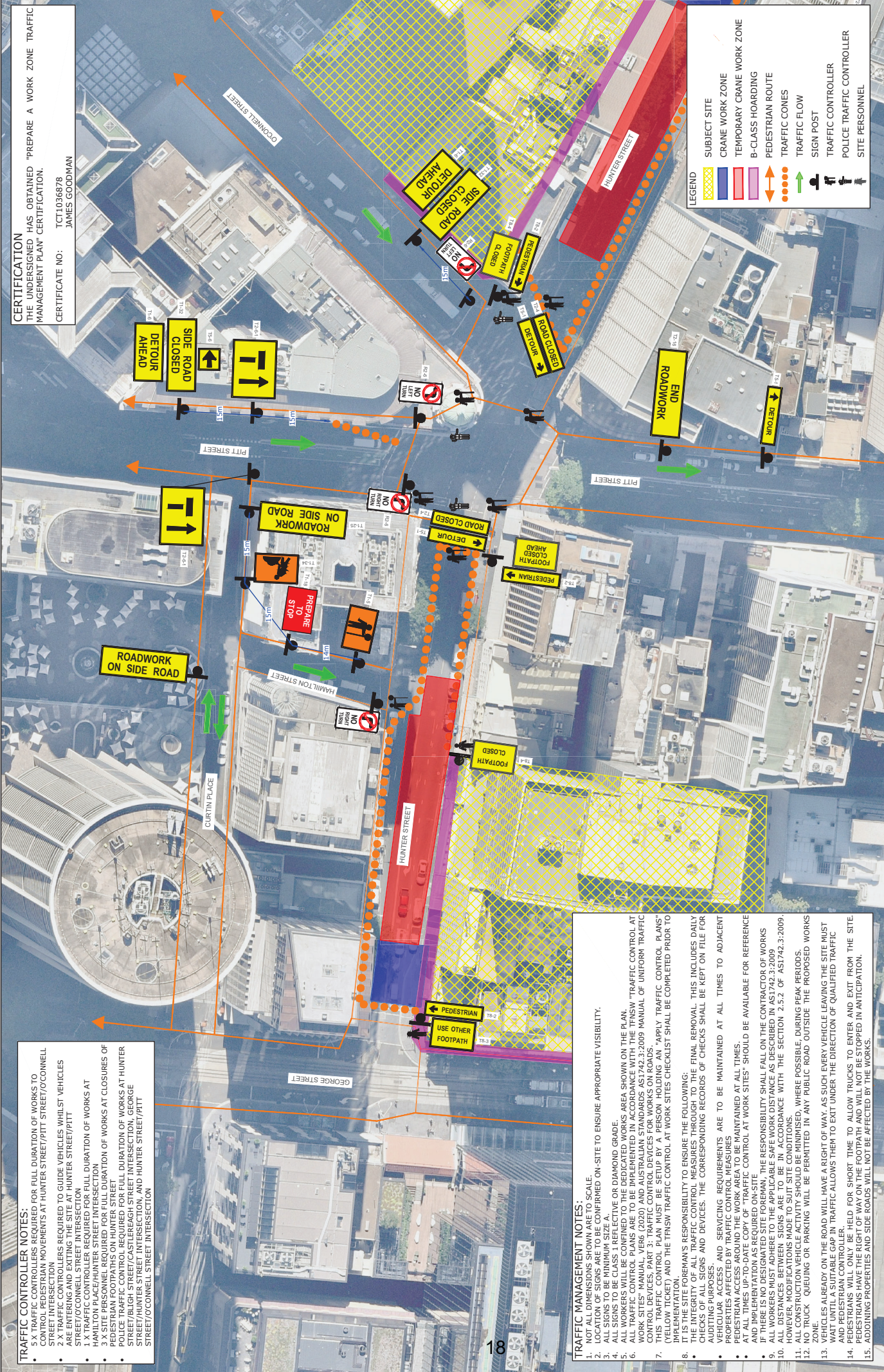

TRAFFIC CONTROLLER NOTES:

- 5 X TRAFFIC CONTROLLERS REQUIRED FOR FULL DURATION OF WORKS TO CONTROL PEDESTRIAN MOVEMENTS AT HUNTER STREET/PITT STREET/O'CONNELL STREET INTERSECTION
- 2 X TRAFFIC CONTROLLERS REQUIRED TO GUIDE VEHICLES WHILEST VEHICLES ARE ENTERING AND EXITING THE SITE AT HUNTER STREET/PITT STREET/O'CONNELL STREET INTERSECTION
- 1 X TRAFFIC CONTROLLER REQUIRED FOR FULL DURATION OF WORKS AT HAMILTON PLACE/HUNTER STREET INTERSECTION
- 3 X SITE PERSONNEL REQUIRED FOR FULL DURATION OF WORKS AT CLOSURES OF PEDESTRIAN FOOTPATHS ON HUNTER STREET
- POLICE TRAFFIC CONTROL REQUIRED FOR FULL DURATION OF WORKS AT HUNTER STREET/BULGH STREET/CASTLEREAGH STREET INTERSECTION, GEORGE STREET/HUNTER STREET AND HUNTER STREET/PITT STREET/O'CONNELL STREET INTERSECTION

TRAFFIC MANAGEMENT NOTES:

- SCALE
- LOCATION OF SIGNS ARE TO BE CONFIRMED ON-SITE TO ENSURE APPROPRIATE VISIBILITY.
- ALL SIGNS TO BE MINIMUM SIZE A.
- ALL SIGNS TO BE CLASS 1 REFLECTIVE OR DIAMOND GRADE.
- ALL WORKERS WILL BE CONFINED TO THE DEDICATED WORKS AREA SHOWN ON THE PLAN.
- ALL TRAFFIC CONTROL PLANS ARE TO BE IMPLEMENTED IN ACCORDANCE WITH THE TNSW "TRAFFIC CONTROL AT WORK SITES" MANUAL, VERG (2020) AND AUSTRALIAN STANDARDS AS1742.3:2009 MANUAL OF UNIFORM TRAFFIC CONTROL SIGNALS AND DEVICES (MUTCD) AND THE TNSW "TRAFFIC CONTROL PLANS" CHECKLIST.
- THIS TRAFFIC CONTROL PLAN MUST BE SETUP BY PERSON HOLDING AN "APPLY TRAFFIC CONTROL PLANS" (YELLOW TICKET) AND THE TNSW TRAFFIC CONTROL AT WORK SITES CHECKLIST SHALL BE COMPLETED PRIOR TO IMPLEMENTATION.
- IT IS THE SITE FOREMAN'S RESPONSIBILITY TO ENSURE THE FOLLOWING:
 - THE INTEGRITY OF ALL TRAFFIC CONTROL MEASURES THROUGH TO THE FINAL REMOVAL. THIS INCLUDES DAILY CHECKS OF ALL SIGNS AND DEVICES. THE CORRESPONDING RECORDS OF CHECKS SHALL BE KEPT ON FILE FOR VERIFICATION.
 - VEHICULAR ACCESS AND SERVICING REQUIREMENTS ARE TO BE MAINTAINED AT ALL TIMES TO ADJACENT PROPERTIES AFFECTED BY TRAFFIC CONTROL MEASURES
 - PEDESTRIAN ACCESS AROUND THE WORK AREA TO BE MAINTAINED AT ALL TIMES.
 - AT ALL TIMES UP-TO-DATE COPY OF "TRAFFIC CONTROL AT WORK SITES" SHOULD BE AVAILABLE FOR REFERENCE AND IMPLEMENTATION AS REQUIRED ON-SITE
 - IF THERE IS NO DESIGNATED SITE FOREMAN, THE RESPONSIBILITY SHALL FALL ON THE CONTRACTOR OF WORKS
 - ALL DISTANCES BETWEEN SIGNS ARE TO BE IN ACCORDANCE WITH THE SECTION 2.5.2 OF AS1742.3:2009. HOWEVER, MODIFICATIONS MADE TO SUIT SITE CONDITIONS.
 - NO TRUCK QUEUING OR PARKING WILL BE PERMITTED IN ANY PUBLIC ROAD OUTSIDE THE PROPOSED WORKS ZONE.
 - VEHICLES ALREADY ON THE ROAD WILL HAVE A RIGHT OF WAY AS SUCH EVERY VEHICLE LEAVING THE SITE MUST WAIT UNTIL A SUITABLE GAP IN TRAFFIC ALLOWS THEM TO EXIT UNDER THE DIRECTION OF QUALIFIED TRAFFIC AND PEDESTRIAN CONTROLLER.
 - PEDESTRIANS WILL ONLY BE HELD FOR SHORT TIME TO ALLOW TRUCKS TO ENTER AND EXIT FROM THE SITE. PEDESTRIANS HAVE THE RIGHT OF WAY ON THE FOOTPATH AND WILL NOT BE STOPPED IN ANTICIPATION.
 - ADJOINING PROPERTIES AND SIDE ROADS WILL NOT BE AFFECTED BY THE WORKS.

PROJECT		SYDNEY METRO WEST HUNTER STREET - HEAVY LIFT CRANAGE	
TITLE		TRAFFIC GUIDANCE SCHEME HUNTER STREET WEST	
REV.	DESCRIPTION	DRAWN/CHECK	DATE
A	ISSUE FOR DISCUSSION	JG DL WJ	11/07/24
DWG No. 21480CAD013		DATE STAMP 11 JULY 2024	
FIGURE 2		SCALE NTS	
PROJECT No. 21480		REV. A	

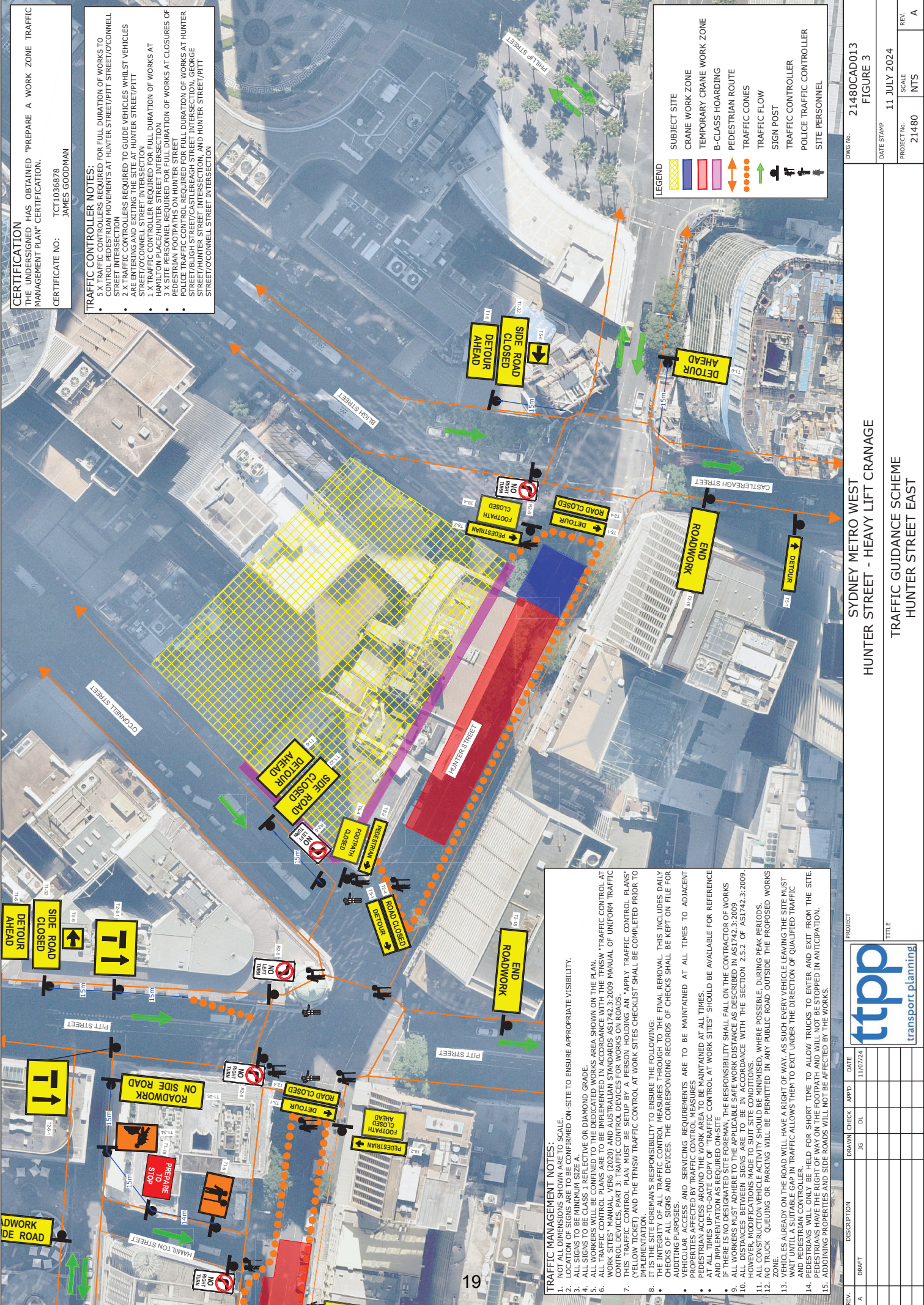

CERTIFICATION
 THE UNDERSIGNED HAS OBTAINED "PREPARE A WORK ZONE TRAFFIC MANAGEMENT PLAN" CERTIFICATION.
 CERTIFICATE NO: TCT1036878
 JAMES GOODMAN

TRAFFIC CONTROLLER NOTES:

- 5 X TRAFFIC CONTROLLERS REQUIRED FOR FULL DURATION OF WORKS TO CONTROL PEDESTRIAN MOVEMENTS AT HUNTER STREET/PITT STREET/O'CONNELL STREET INTERSECTION
- 2 X TRAFFIC CONTROLLERS REQUIRED TO GUIDE VEHICLES WHILST VEHICLES ARE ENTERING AND EXITING THE SITE AT HUNTER STREET/PITT STREET/O'CONNELL STREET INTERSECTION
- 1 X TRAFFIC CONTROLLER REQUIRED FOR FULL DURATION OF WORKS AT HAMILTON PLACE/HUNTER STREET INTERSECTION
- 3 X SITE PERSONNEL REQUIRED FOR FULL DURATION OF WORKS AT CLOSURES OF PEDESTRIAN FOOTPATHS ON HUNTER STREET
- POLICE TRAFFIC CONTROL REQUIRED FOR FULL DURATION OF WORKS AT HUNTER STREET/BLIGH STREET/CASTLEREAGH STREET INTERSECTION, GEORGE STREET/O'CONNELL STREET INTERSECTION

LEGEND

- SUBJECT SITE
- CRANE WORK ZONE
- TEMPORARY CRANE WORK ZONE
- B-CLASS HOARDING
- PEDESTRIAN ROUTE
- TRAFFIC CONES
- TRAFFIC FLOW
- SIGN POST
- TRAFFIC CONTROLLER
- POLICE TRAFFIC CONTROLLER
- SITE PERSONNEL

TRAFFIC MANAGEMENT NOTES:

- SCALE
- LOCATION OF SIGNS ARE TO BE CONFIRMED ON-SITE TO ENSURE APPROPRIATE VISIBILITY.
- ALL SIGNS TO BE MINIMUM SIZE A.
- ALL WORKERS WILL BE CONFINED TO THE DEDICATED WORKS AREA SHOWN ON THE PLAN.
- ALL TRAFFIC CONTROL PLANS ARE TO BE IMPLEMENTED IN ACCORDANCE WITH THE TNSW "TRAFFIC CONTROL AT WORK SITES" MANUAL, VER6 (2020) AND AUSTRALIAN STANDARDS AS1742.3:2009 MANUAL OF UNIFORM TRAFFIC CONTROL SIGNALS AND DEVICES (MUTCD).
- THIS TRAFFIC CONTROL PLAN MUST BE SETUP BY PERSON HOLDING AN "APPLY TRAFFIC CONTROL PLANS" (YELLOW TICKET) AND THE TNSW TRAFFIC CONTROL AT WORK SITES CHECKLIST SHALL BE COMPLETED PRIOR TO IMPLEMENTATION.
- IT IS THE SITE FOREMAN'S RESPONSIBILITY TO ENSURE THE FOLLOWING:
 - THE INTEGRITY OF ALL TRAFFIC CONTROL MEASURES THROUGH TO THE FINAL REMOVAL. THIS INCLUDES DAILY CHECKS OF ALL SIGNS AND DEVICES. THE CORRESPONDING RECORDS OF CHECKS SHALL BE KEPT ON FILE FOR VEHICULAR ACCESS AND SERVICING REQUIREMENTS ARE TO BE MAINTAINED AT ALL TIMES TO ADJACENT PROPERTIES AFFECTED BY TRAFFIC CONTROL MEASURES
 - PEDESTRIAN ACCESS AROUND THE WORK AREA TO BE MAINTAINED AT ALL TIMES.
 - AT ALL TIMES UP-TO-DATE COPY OF "TRAFFIC CONTROL AT WORK SITES" SHOULD BE AVAILABLE FOR REFERENCE AND IMPLEMENTATION AS REQUIRED ON-SITE
 - IF THERE IS NO DESIGNATED SITE FOREMAN, THE RESPONSIBILITY SHALL FALL ON THE CONTRACTOR OF WORKS
 - ALL DISTANCES BETWEEN SIGNS ARE TO BE IN ACCORDANCE WITH THE SECTION 2.5.2 OF AS1742.3:2009. HOWEVER, MODIFICATION VEHICLE ACTIVITY SHOULD BE MINIMISED, WHERE POSSIBLE, DURING PEAK PERIODS.
 - ALL CONSTRUCTION VEHICLE ACTIVITY SHOULD BE MINIMISED, WHERE POSSIBLE, DURING PEAK PERIODS.
 - NO TRUCK QUEUING OR PARKING WILL BE PERMITTED IN ANY PUBLIC ROAD OUTSIDE THE PROPOSED WORKS ZONE.
 - VEHICLES ALREADY ON THE ROAD WILL HAVE A RIGHT OF WAY, AS SUCH EVERY VEHICLE LEAVING THE SITE MUST MAINTAIN A SUITABLE GAP. TRAFFIC ALLOWS THEM TO EXIT UNDER THE DIRECTION OF QUALIFIED TRAFFIC AND PEDESTRIAN CONTROLLER.
 - PEDESTRIANS WILL ONLY BE HELD FOR SHORT TIME TO ALLOW TRUCKS TO ENTER AND EXIT FROM THE SITE. PEDESTRIANS HAVE THE RIGHT OF WAY ON THE FOOTPATH AND WILL NOT BE STOPPED IN ANTICIPATION.
 - ADJOINING PROPERTIES AND SIDE ROADS WILL NOT BE AFFECTED BY THE WORKS.

REV.	DESCRIPTION	DRAWN	CHECK	APP'D	DATE
A		JG	DL		13/07/24

PROJECT: SYDNEY METRO WEST
 HUNTER STREET - HEAVY LIFT CRANAGE
 TITLE: TRAFFIC GUIDANCE SCHEME HUNTER STREET EAST

DWG No: 21480CAD013
 FIGURE 3

DATE STAMP: 11 JULY 2024

PROJECT No: 21480
 SCALE: NTS
 REV: A



	ROAD CLOSURE
	SIGN POST
	TRAFFIC CONTROLLER
	PITT STREET TRAFFIC EASTBOUND DETOUR
	HUNTER/BLIGH STREET TRAFFIC WESTBOUND DETOUR

TRAFFIC CONTROLLERS AT THE INTERSECTION OF BENT STREET/BLIGH STREET AND O'CONNELL STREET DIRECTING LAYOVER BUSES TO BLIGHT STREET AND STOPPING BUSES FROM ENTERING O'CONNELL STREET

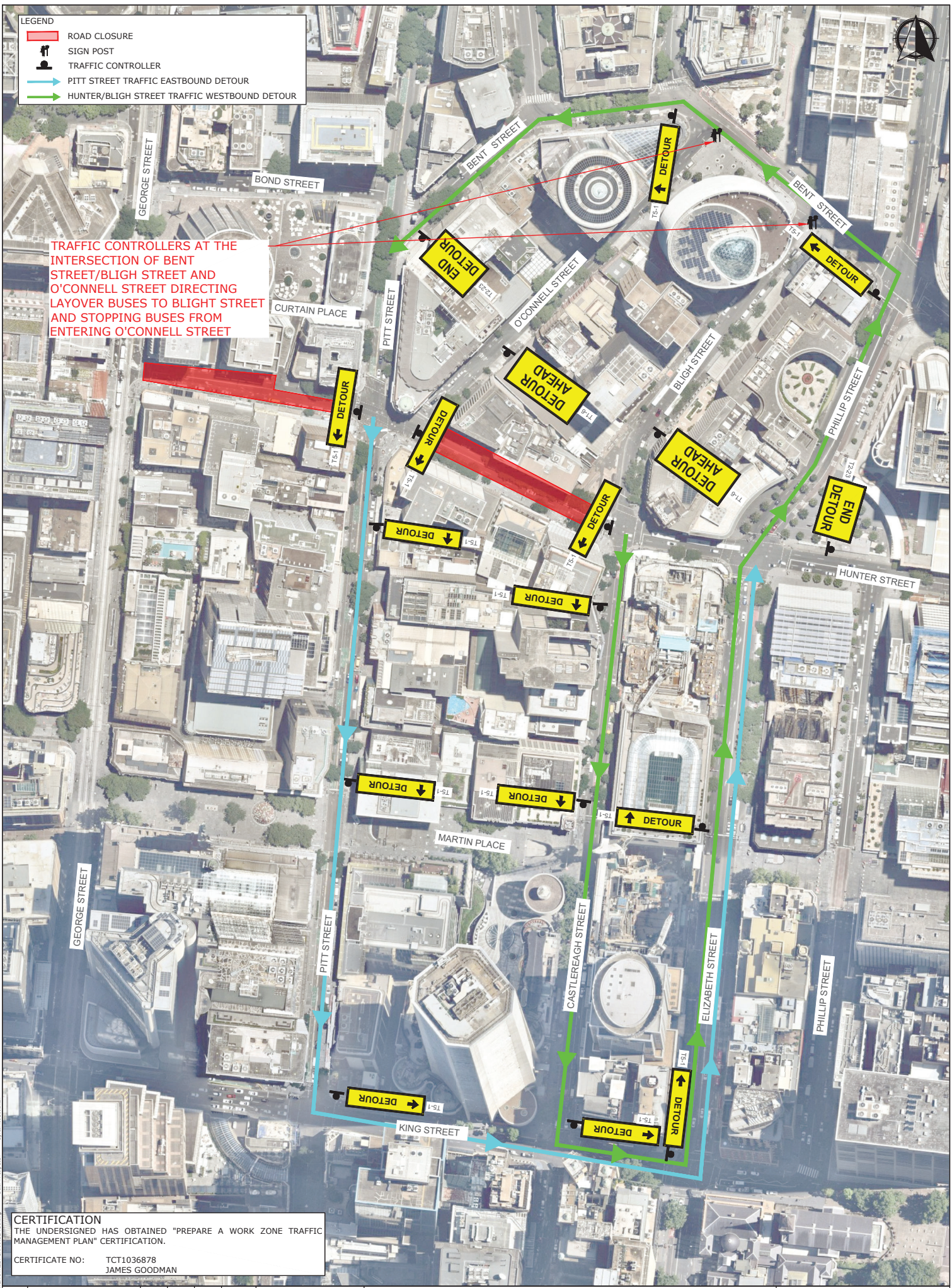

CERTIFICATION
 THE UNDERSIGNED HAS OBTAINED "PREPARE A WORK ZONE TRAFFIC MANAGEMENT PLAN" CERTIFICATION.
 CERTIFICATE NO: TCT1036878
 JAMES GOODMAN

REV.	DESCRIPTION	DRAWN	CHECK	APP'D	DATE
A	ISSUE FOR DISCUSSION	JG	DL	WJ	11/07/24



PROJECT: SYDNEY METRO WEST
 HUNTER STREET - HEAVY LIFT CRANAGE
 TITLE: TRAFFIC GUIDANCE SCHEME
 DETOUR PLAN

DWG No.	21480CAD013	
	FIGURE 4	
DATE STAMP	11 JULY 2024	
PROJECT No.	SCALE	REV.
21480	NTS	A

File name: 21480CAD013-202411-11-HUNTER STREET CRANAGE TOS.dwg Date: 11 July 2024 By: James Goodman